



# Target Screen User Manual





## Table Of contents

Page	4	-	Contents of kit and tools required
Page	5	-	Assembly
Page	7	-	Using the screen
Page	8	-	Parts list and explosions

### **\*\*\*\*\* LIMITED LIABILITY WARRANTY \*\*\*\*\***

*This product is warranted to the retail customer for 12 months from date of purchase against defects in materials and workmanship and is transferable to any subsequent owner.*

*Proof of purchase is required to receive warranty repairs, retain your purchase invoice and return the warranty registration card as soon as possible after purchase. The warranty card must show the dealer/supplier name and address and date of purchase.*

#### ***What is covered***

*Replacement parts & labour on a 'back to base' basis, return transportation to the consumer (mainland UK only).*

#### ***What is not covered***

*Transportation from the consumer to Air Arms.*

*Damage caused by misuse, abuse, lack of routine maintenance, transit damage between the dealer/supplier and the consumer or unauthorized disassembly.*

*Parts subject to normal wear and tear.*

*Any other consequential cost incurred by the consumer.*

*Return transportation to consumers outside mainland UK.*

***No warranty is implied as to the fitness for any particular purpose.***

***Air Arms reserves the right to make changes without prior notice.***

***Air Arms  
Unit 5 - 6,  
Hailsham Industrial Park,  
Diplocks Way,  
Hailsham,  
East Sussex BN27 3JF.***

***www.air-arms.co.uk  
general@air-arms.co.uk  
01323 845853***

## Contents of kit

The Air Arms target screen is a self assembly portable behind target screen designed for low power air rifles and pistols.

The kit comprises of a metal frame work with thick flexible PVC sheets hung in a over-lapping curtain configuration. It is important that the PVC sheets over-lap to make sure that no stray pellets make it between the sheets during use. If the assembly instructions are followed the sheets will lay in an over and under pattern.

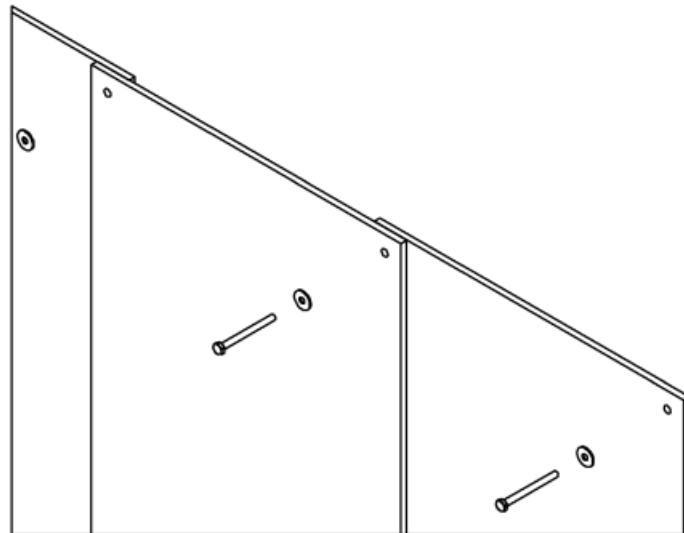

The kit will contain.

2	x	Frame upright assemblies
1	x	Frame top bar assembly
2	x	Feet
6	x	Plastic bungs
4	x	M8 nyloc nuts
4	x	M8 washers
16	x	3/4 washers
8	x	M6 nyloc nuts
8	x	M6 x 65 bolts
7	x	PVC sheets
4	x	Fixing pegs, guy rope and toggles
1	x	Wall bracket and bolt

Tools required.

13mm socket to fit the M8 nuts.

10mm spanners for the M6 bolts and nuts.

# Assembly

Fit the feet (No. 3) to the bottom of the uprights (No. 2) using a M8 nyloc nut and washer (No. 5 & 6). The feet have two holes cut into them, an 8.2mm hole for the bolt and a 20mm for clearance on the socket. The 20mm hole goes to the bottom of the assembly. On the bottom of the upright there is a flange, this flange needs to face front to back along the foot. Two plastic bungs (No. 4) can be pushed into the end of the feet.

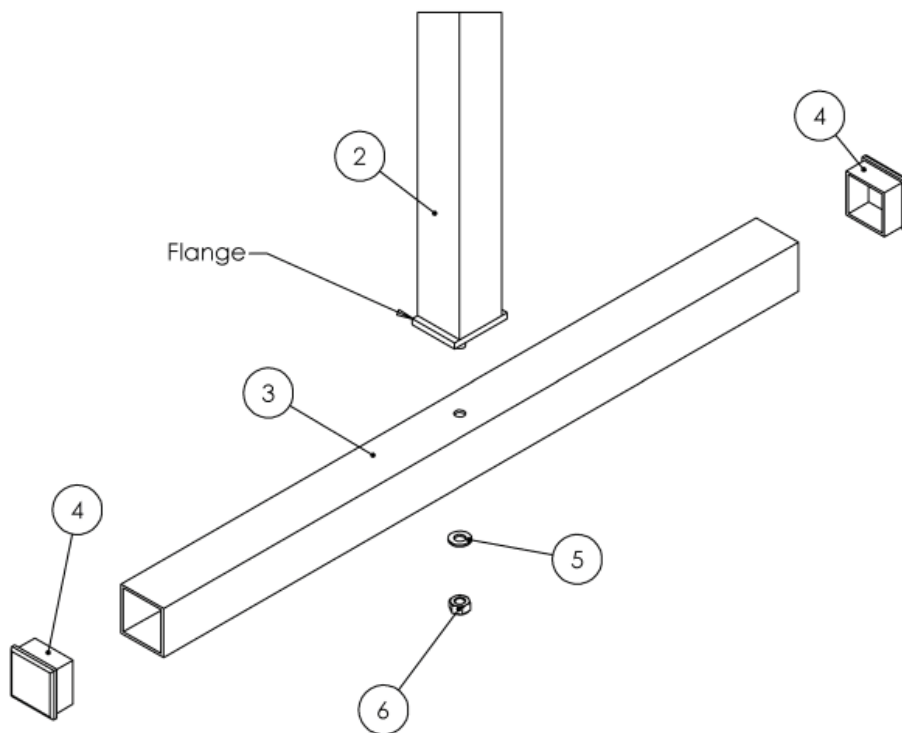

To fit the top bar to the uprights, slip the top bar (No.1) onto the M8 stud at the top of the upright assembly (No.2). The flange on the top of the upright must go left to right in line with the frame top bar assembly, also the hooks need to face front to back. Fix the bolt with a M8 nyloc nut and washer (No. 6 & 5). The bung (No. 4) can now be pushed into the end of the top member.

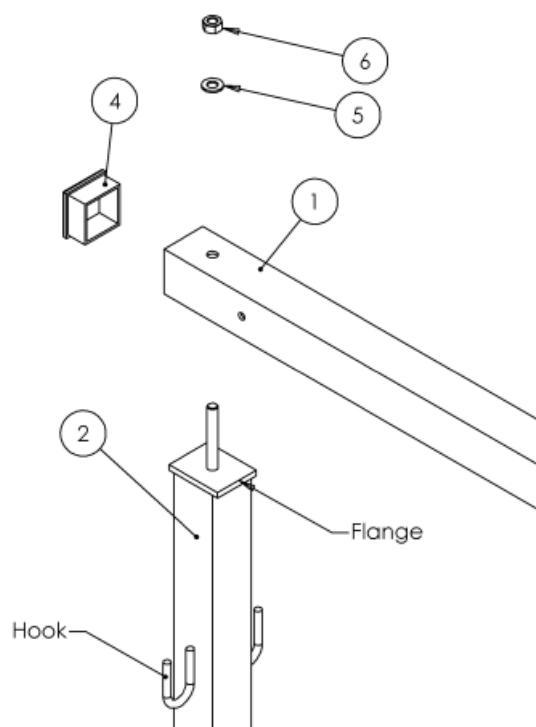

Once the frame work has been assembled and the nuts tightened the 7 PVC sheets (No. 11) can be mounted to the top member (No. 1). Each sheet needs to be secured with two screws each passing through two PVC sheets, except the end screws which pass through one sheet.

Pass the M6 bolts (No. 13) with a washer fitted (No. 12), through from the front of the sheet and frame top bar assembly and secure with a M6 nyloc nut and washer from the rear.

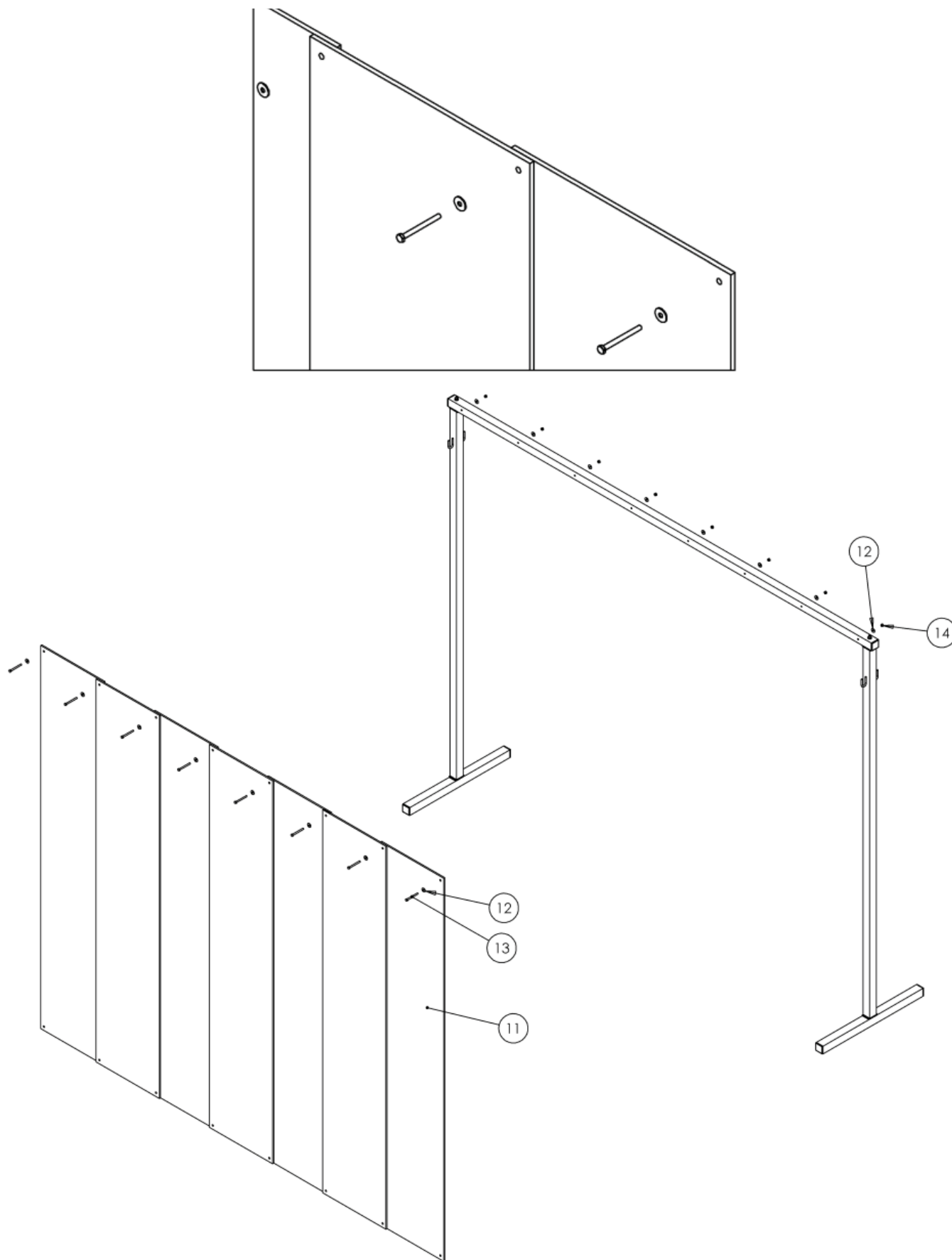

# Using the screen

## Positioning the screen

This screen has been designed for use with or without guy ropes. It is recommend that if the frame is used on soft ground the guy rope should be used to aid stability. If the frame is used on flat level ground the guy rope may not be necessary.

There is a wall bracket supplied in the kit. This allows the frame to be mounted to the wall on one side of the frame. The frame can then be folded away against the wall if needed. It is possible to use the frame with or without a leg if mounted against the wall.



## Shooting

When using the screen the target should be placed about 30cm in front of the curtain, where possible in the centre of the frame, this will allow as much protected area as possible.

The screen has been designed for low powered air rifles and pistol shooting from a distance of 10 meters. Using higher power airguns or other types of rifles or pistols may damage the screens.

**NOTE: The screens should be inspected before and after use to make sure they are sound. The curtains have fixing holes top and bottom so can be turned around if necessary. Spare curtains are available from Air Arms. See parts lists at the back of the manual.**

ITEM NO.	PART NUMBER	DESCRIPTION	QTY.
1	TS07A	FRAME UPRIGHT ASSEMBLY - TARGET SCREENS	2
2	TS06	FRAME FOOT	2
3	SNKR20	BUNG	6
4	T2016	M8 X 25 X 1.5 WASHER	4
5	T0071SP	M8 NYLOC NUT	4
6	TS01	PVC SCREENS	7
7	RW27	3/4 X 1/4 X 17G WASHER	16
8	TS11	M6 X 65 BOLT	8
9	RW13	M6 NYLOC NUT	8
10	TS13A	FRAME TOP BAR ASSY	1
11	TS02	WALL BRACKET - TARGET SCREEN	1

The screw for the wall bracket to the frame if you are not using the leg is Part No. SNKR26.

The guy ropes and Part No. TS03.

The guy sliders are Part No. TS04.

Please use the above Part Number when ordering replacement parts.

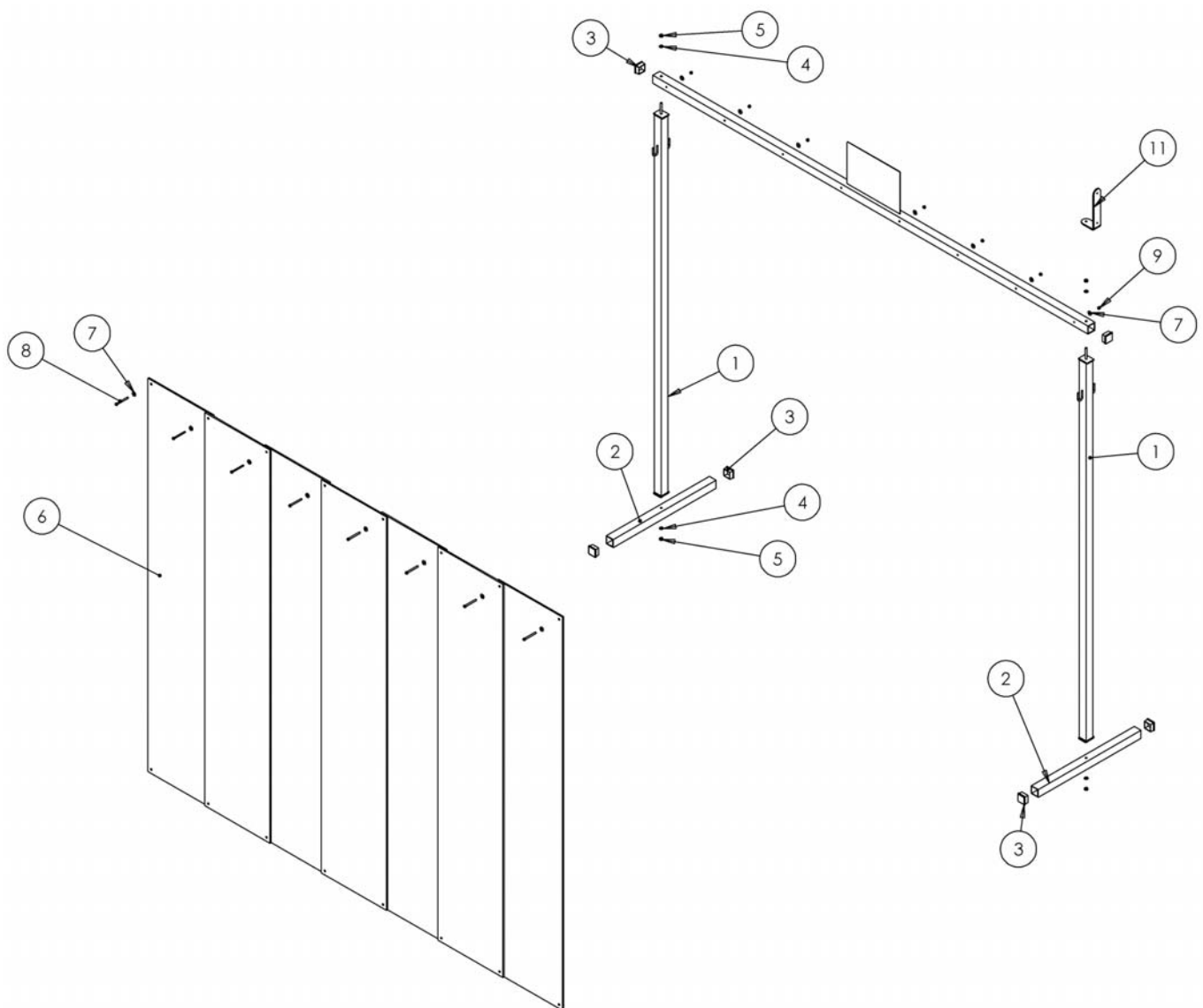



NOTES: