

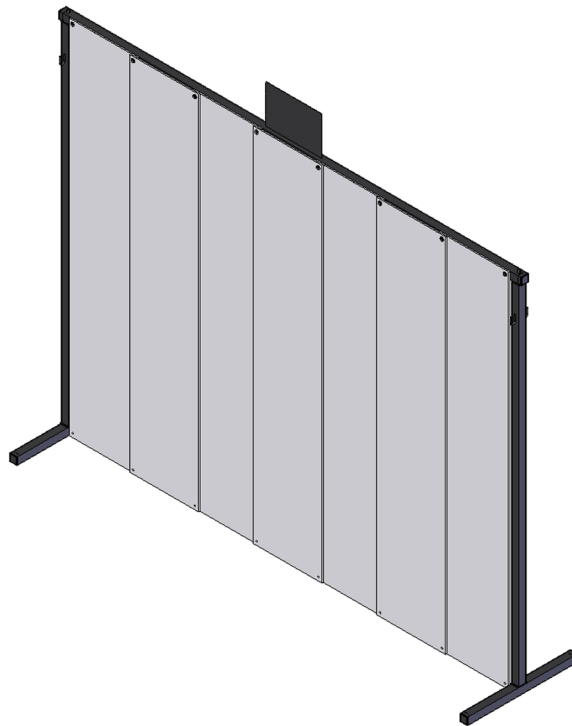

# Target Screen User Manual





## Table Of contents

Page	4	-	Contents of kit and tools required
Page	5	-	Assembly
Page	7	-	Using the screen
Page	8	-	Parts list and explosions

### **\*\*\*\*\* LIMITED LIABILITY WARRANTY \*\*\*\*\***

*This product is warranted to the retail customer for 12 months from date of purchase against defects in materials and workmanship and is transferable to any subsequent owner.*

*Proof of purchase is required to receive warranty repairs, retain your purchase invoice and return the warranty registration card as soon as possible after purchase. The warranty card must show the dealer/supplier name and address and date of purchase.*

#### ***What is covered***

*Replacement parts & labour on a 'back to base' basis, return transportation to the consumer (mainland UK only).*

#### ***What is not covered***

*Transportation from the consumer to Air Arms.*

*Damage caused by misuse, abuse, lack of routine maintenance, transit damage between the dealer/supplier and the consumer or unauthorized disassembly.*

*Parts subject to normal wear and tear.*

*Any other consequential cost incurred by the consumer.*

*Return transportation to consumers outside mainland UK.*

***No warranty is implied as to the fitness for any particular purpose.***

***Air Arms reserves the right to make changes without prior notice.***

***Air Arms  
Unit 5 - 6,  
Hailsham Industrial Park,  
Diplocks Way,  
Hailsham,  
East Sussex BN27 3JF.***

***www.air-arms.co.uk  
general@air-arms.co.uk  
01323 845853***

# Contents of kit

The Air Arms target screen is a self assembly portable behind target screen designed for low power air rifles and pistols.

The kit comprises of a metal frame work with thick flexible PVC sheets hung in a over-lapping curtain configuration. It is important that the PVC sheets over-lap to make sure that no stray pellets make it between the sheets during use. If the assembly instructions are followed the sheets will lay in an over and under pattern.

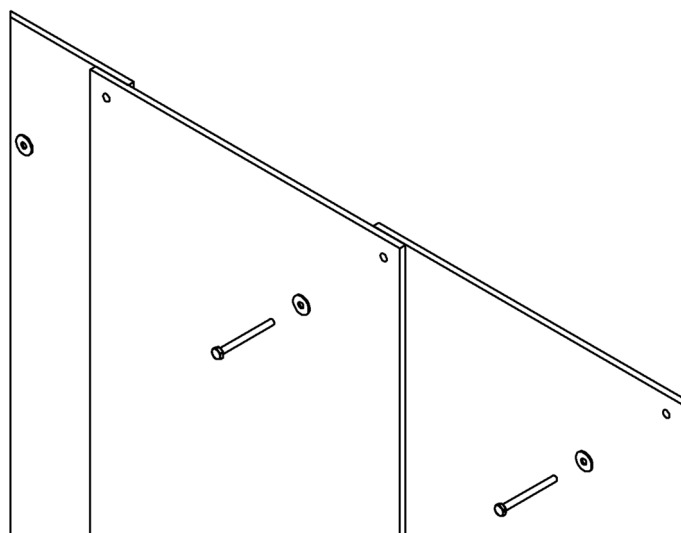

## Target screens

2	x	Frame upright assemblies
1	x	Frame top bar
2	x	Feet
6	x	Plastic bungs
4	x	M8 nyloc nuts
4	x	M8 washers
16	x	3/4 washers
8	x	M6 nyloc nuts
8	x	M6 bolts
7	x	PVC sheets
4	x	Fixing pegs, guy rope and toggles
1	x	Wall bracket and bolt
1	x	Label plate
1	x	Label
2	x	Foam strips
1	x	Bolt protection sheet

## Pellet catcher

3	x	Target holder assemblies
3	x	Pellet catchers
12	x	M5 washers
8	x	M8 washers
6	x	M5 bolts
4	x	M8 nyloc nuts
6	x	Pellet catcher mounting boss
2	x	Mounting bar brackets
1	x	2.5m mounting bar
12	x	10 x 1 1/2" woodscrews
4	x	M8 bolts
6	x	M5 nyloc nuts

Tools required.

13mm socket to fit the M8 nuts.

10mm spanners for the M6 bolts and nuts.

8mm spanners for the M5 bolts and nuts.

Cross head screw driver.

# Assembly

Fit the feet (No. 3) to the bottom of the uprights (No. 2) using a M8 nyloc nut and washer (No. 5 & 6). The feet have two holes cut into them, an 8.2mm hole for the bolt and a 20mm for clearance on the socket. The 20mm hole goes to the bottom of the assembly. On the bottom of the upright there is a flange, this flange needs to face front to back along the foot. Two plastic bungs (No. 4) can be pushed into the end of the feet.

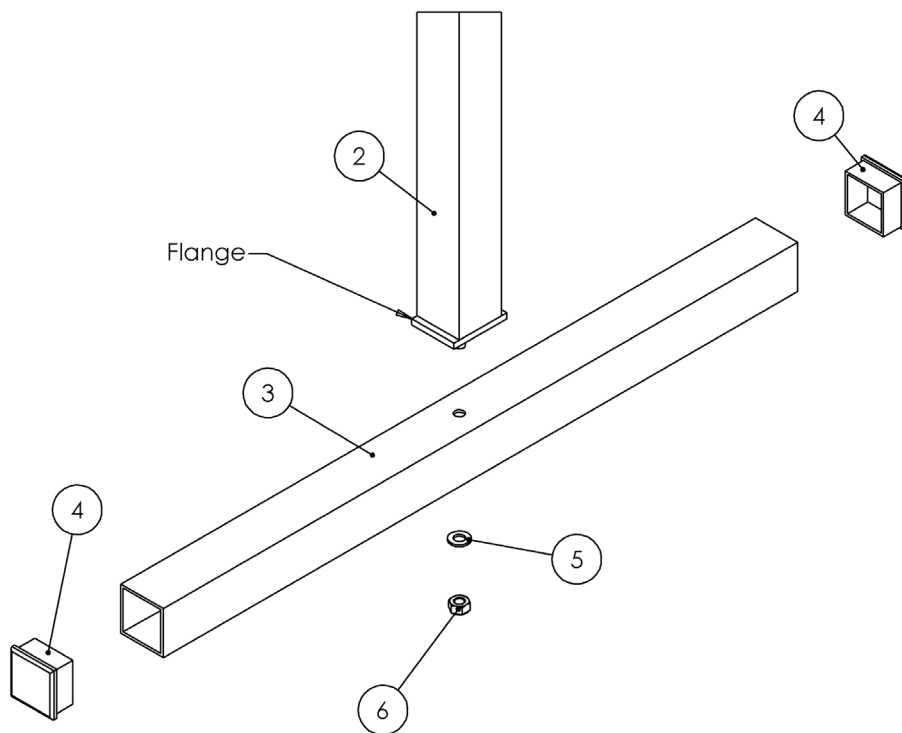

To fit the top bar to the uprights, slip the top bar (No.1) onto the M8 stud at the top of the upright assembly (No.2). The flange on the top of the upright must go left to right in line with the frame top bar assembly, also the hooks need to face front to back. Fix the bolt with a M8 nyloc nut and washer (No. 6 & 5). The bung (No. 4) can now be pushed into the end of the top member.

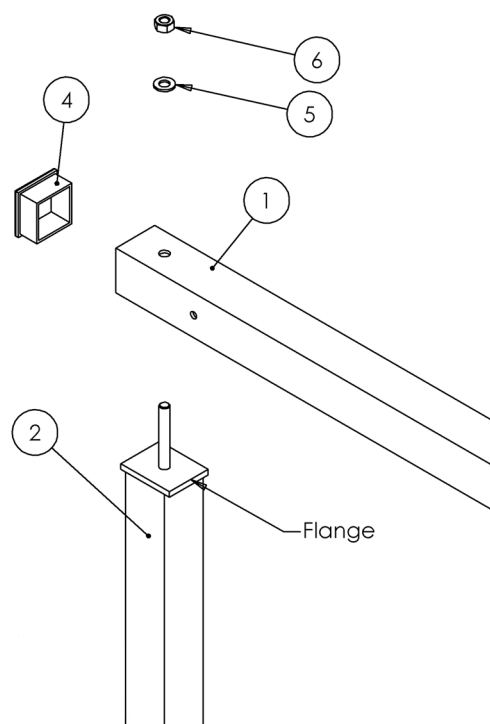

Once the frame work has been assembled and the nuts tightened the 7 PVC sheets (No. 11) can be mounted to the top member (No. 1). Each sheet needs to be secured with two bolts each passing through two PVC sheets, except the end bolts which pass through one sheet. Lay the sheets in an over and under pattern as shown below.

Pass the M6 bolts (No. 13) with a washer fitted (No. 12), through from the protective sheet and then the main sheets and frame top bar and secure with the M6 nyloc nuts and washers. Now pull the protective sheet over the top and onto the bolt from the rear and fix with another washer and nut. The logo plate can also be mounted on these bolts.

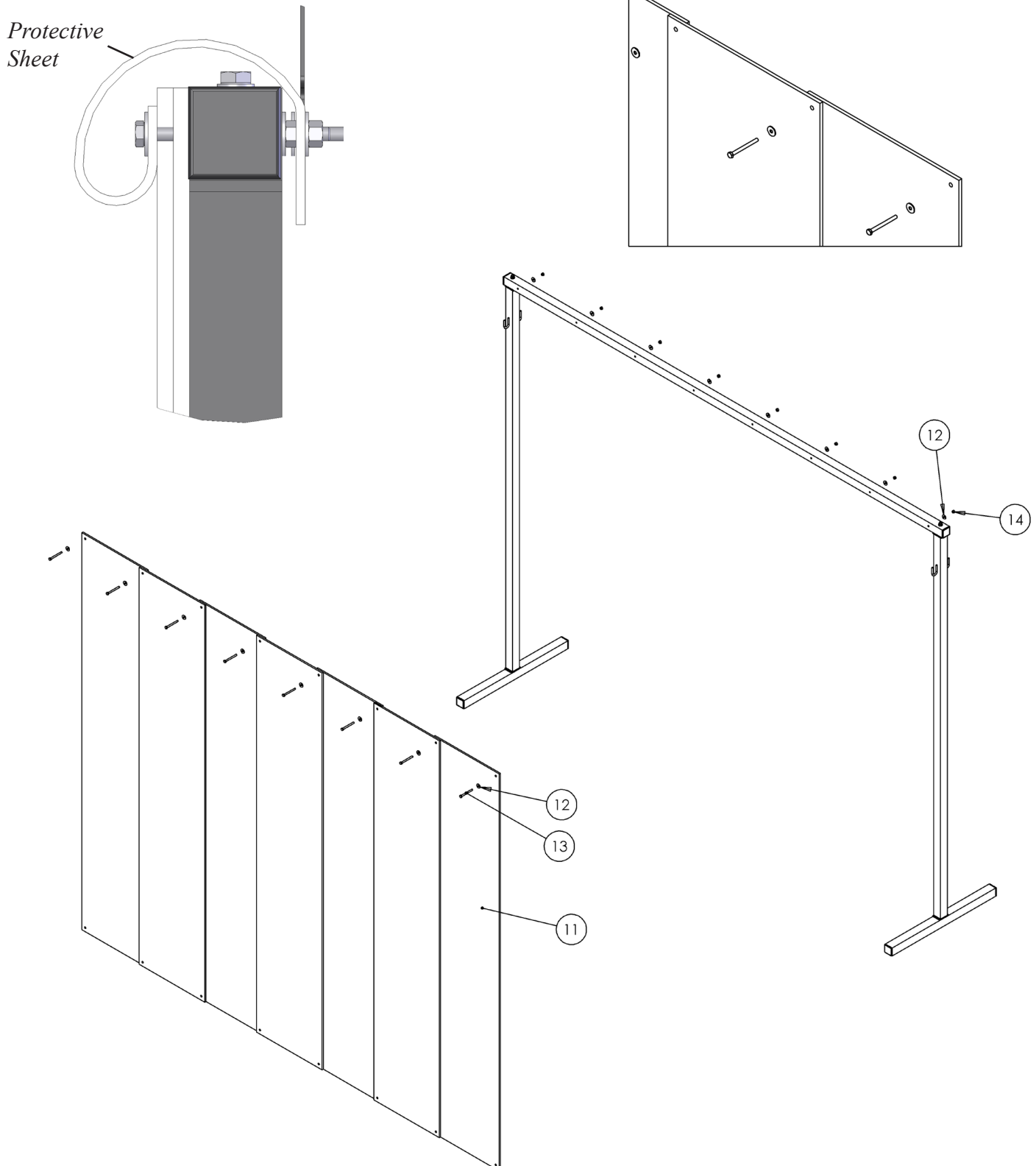

There is two lengths of self adhesive foam in the kit. These are for the front of the upright. If the uprights get hit by a stray pellet the foam absorbs the energy and stops ricochets.

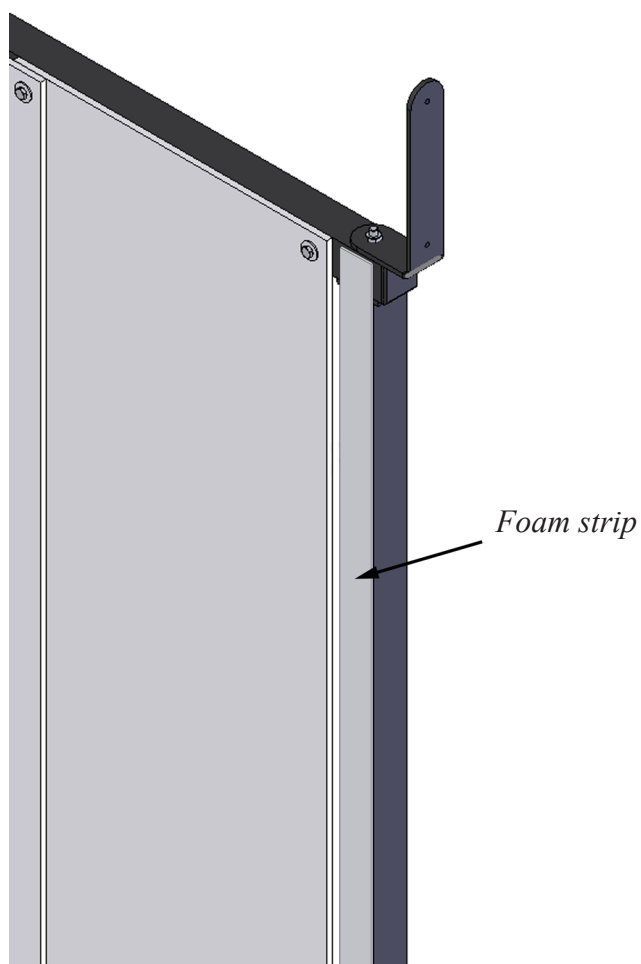

# Using the screen

## Positioning the screen

This screen has been designed for use with or without guy ropes. It is recommend that if the frame is used on soft ground the guy rope should be used to aid stability. If the frame is used on flat level ground the guy rope may not be necessary.

There is a wall bracket supplied in the kit. This allows the frame to be mounted to the wall on one side of the frame. The frame can then be folded away against the wall if needed. It is possible to use the frame with or without a leg if mounted against the wall.

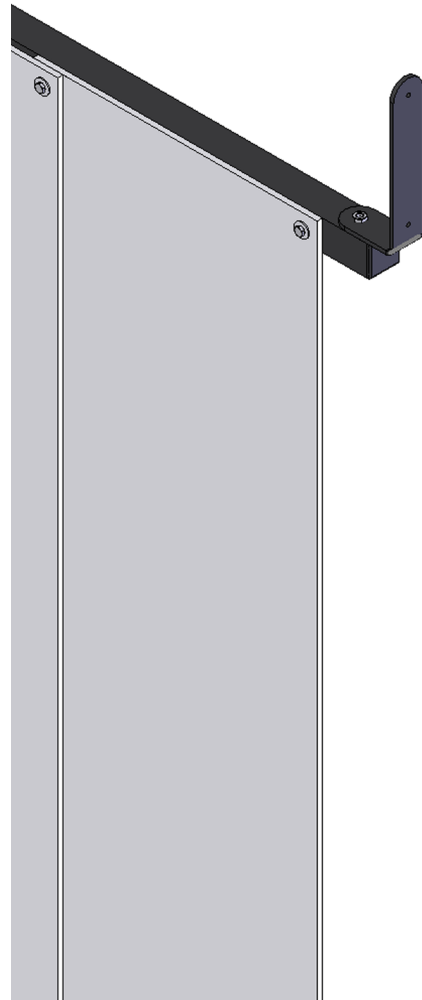
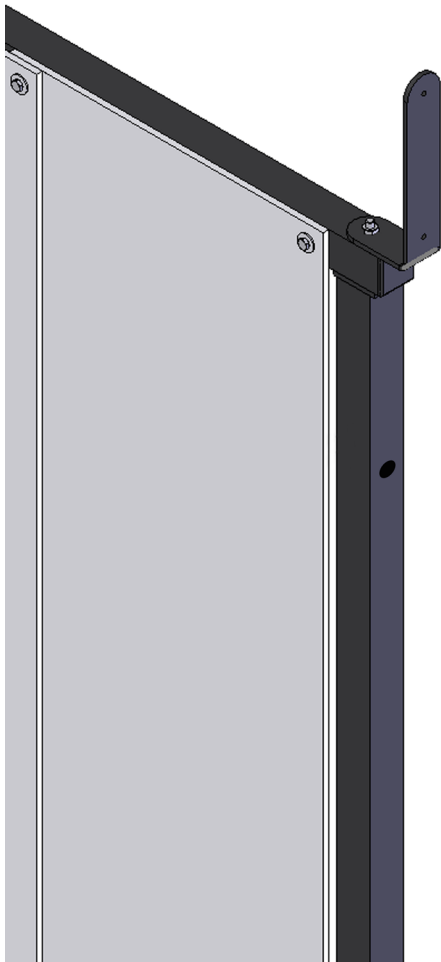



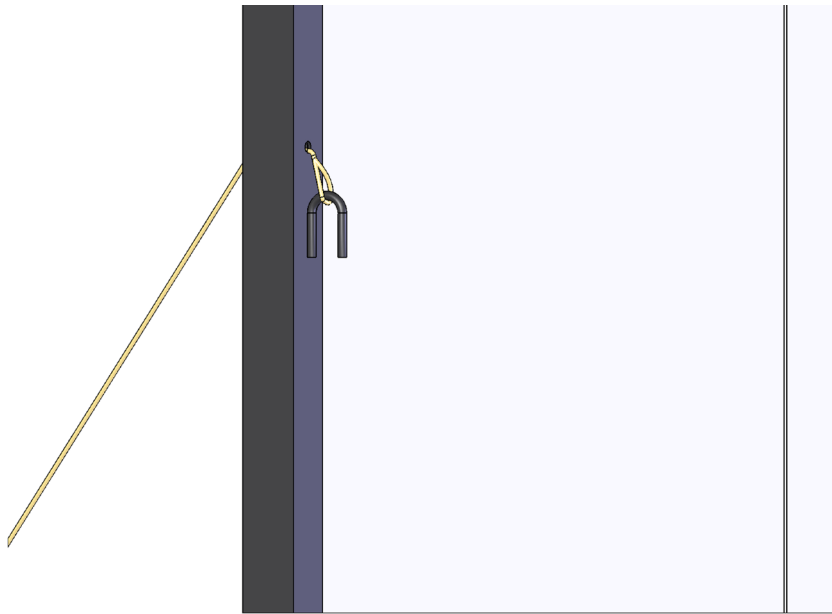

## Shooting

When using the screen the target should be placed about 30cm in front of the curtain, where possible in the centre of the frame, this will allow as much protected area as possible.

The screen has been designed for low powered air rifles and pistol shooting from a distance of 10 meters. Using higher power airguns or other types of rifles or pistols may damage the screens.

**NOTE: The screens should be inspected before and after use to make sure they are sound. The curtains have fixing holes top and bottom so can be turned around if necessary. Spare curtains are available from Air Arms. See parts lists at the back of the manual.**

# The Target Holder assembly

The target holder assembly comprises of three pellet catchers and target holders mounted to a wooden bar. This bar can be fitted to the Target Screens at three height positions.

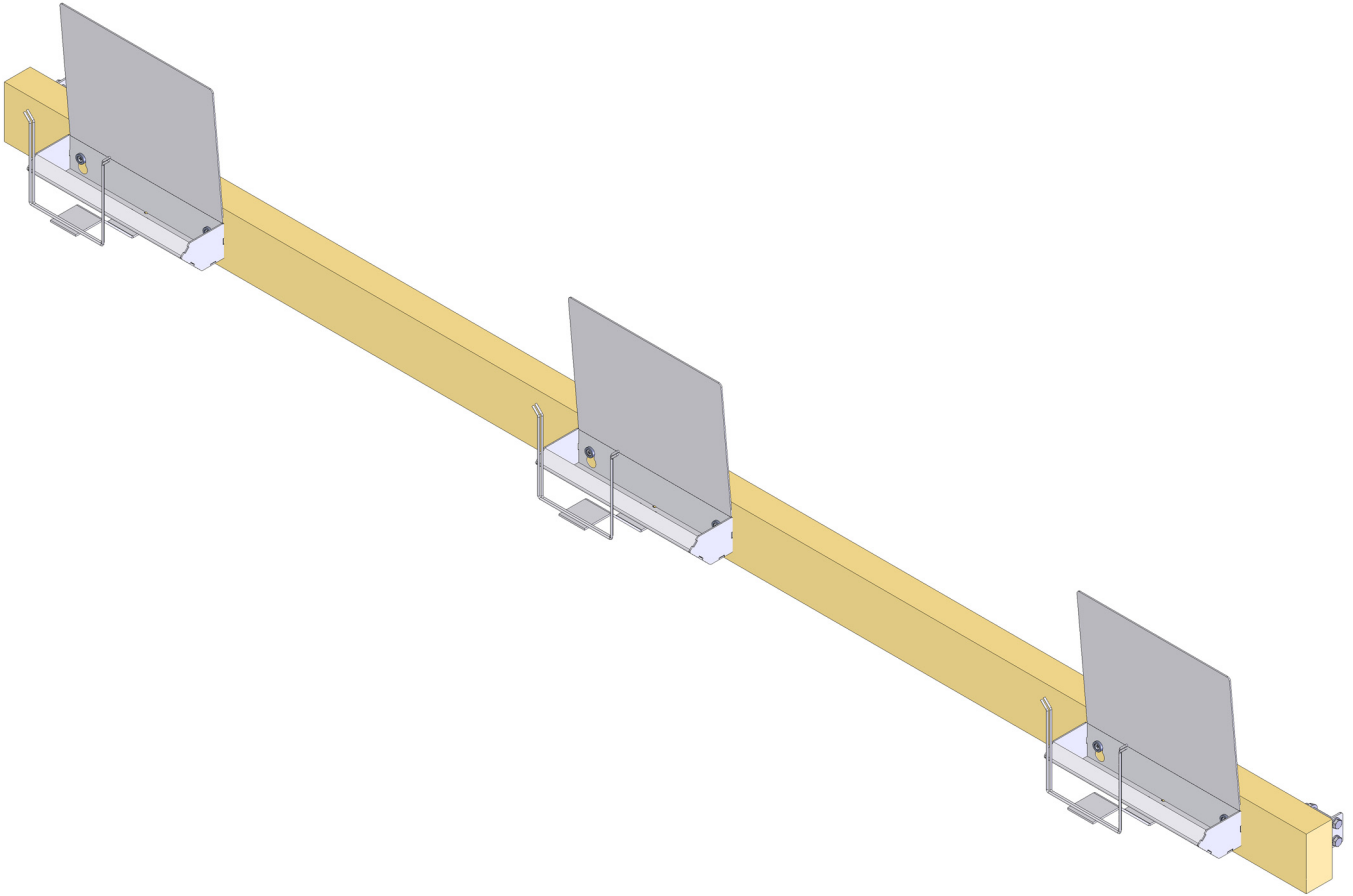

The assembly of the target holder is straight forward and you will find an exploded diagram in the back of this manual showing where all the parts go.

One area requires extra mention. The mounting boss (No.10) for the pellet catcher must not be over tightened as this may make it difficult to slide the keyway on the back of the pellet catcher over the boss.

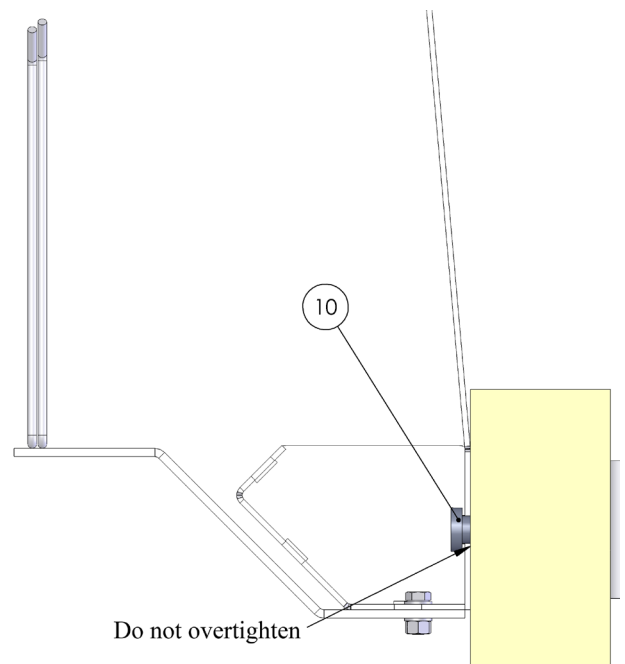

The pellet catcher can be set to three different positions on the target screen. These are for standing, kneeling and prone.

There are holes to bolt the pellet catcher assembly to the frame in the three positions requires, use the M8 bolt, nuts and washers provided no (No.15, 10 & 9).

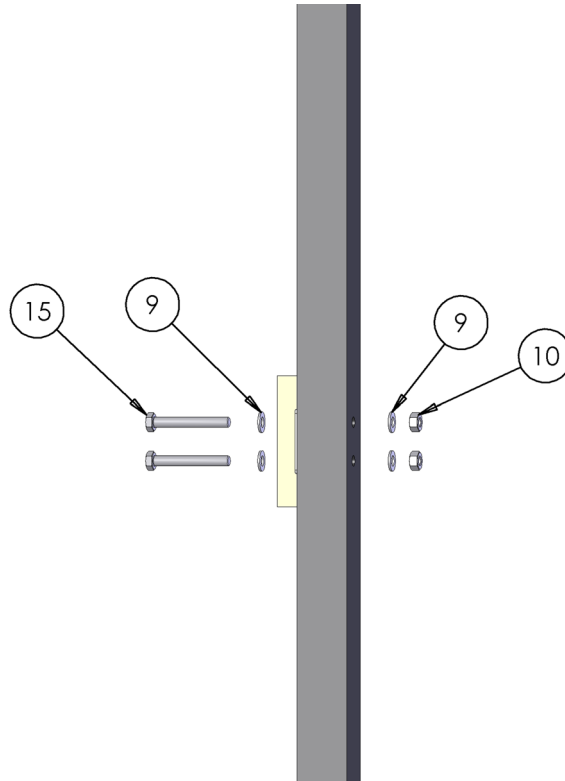

ITEM NO.	PART NUMBER	DESCRIPTION	QTY.
1	TS07A	FRAME UPRIGHT ASSEMBLY - TARGET SCREENS	2
2	TS06	FRAME FOOT	2
3	SNKR20	BUNG	6
4	T2016	M8 X 25 X 1.5 WASHER	4
5	T0071SP	M8 NYLOC NUT	4
6	TS01	PVC SCREENS	7
7	RW27	3/4 X 1/4 X 17G WASHER	16
8	TS11	M6 X 65 BOLT	8
9	RW13	M6 NYLOC NUT	8
10	TS13A	FRAME TOP BAR ASSY	1
11	TS02	WALL BRACKET - TARGET SCREEN	1

### Parts not shown on the diagram

Foam strip for the front of the legs.

Protective sheet for the bolts that hold the hangings sheets in place.

The screw for the wall bracket to the frame if you are not using the leg is Part No. SNKR26.

The guy ropes and Part No. TS03.

The guy sliders are Part No. TS04.

Please use the above Part Number when ordering replacement parts.

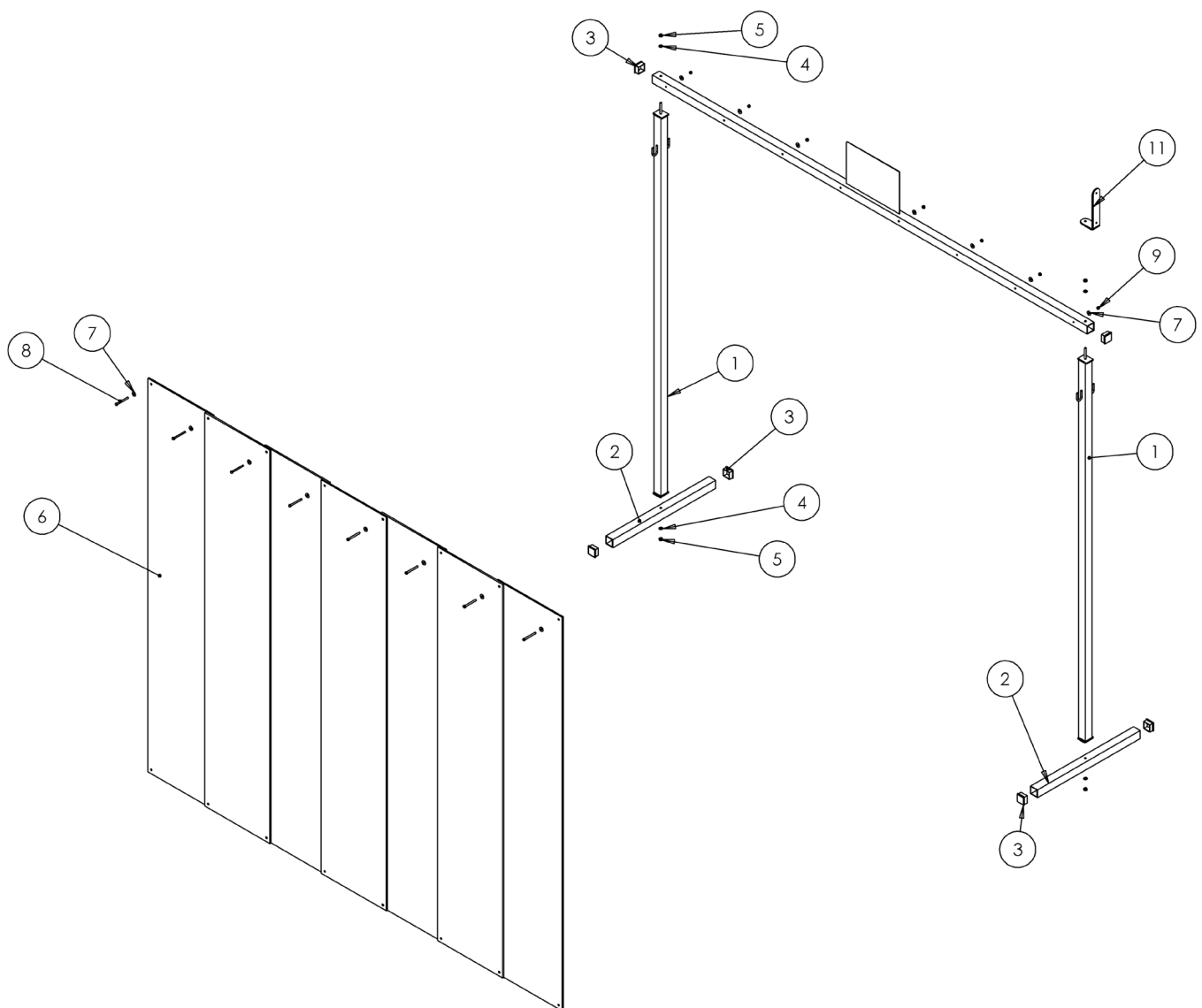

ITEM NO.	PART NUMBER	DESCRIPTION	QTY.
1	TS15	TARGET HOLDER ASSEMBLY	3
2	TS14	PELLET CATCHER	3
3	RW35	M5 WASHER	12
4	T2016	M8 WASHER	8
5	KDT009	M5 BOLT	6
6	T0071SP	M8 NYLOC NUT	4
7	TS17	PELLET CATCHER MOUNTING BOSS	6
8	TS16-25	2.5M MOUNTING BAR	1
9	TS18	MOUNTING BAR ANGLE BRACKET	2
10	TS20	10 x 1 1/2" WOOD SCREW	12
11	SNKR26	M8 X 60 BOLT	4
12	KDT005	M5 NYLOC NUT	6

