



Target Screen & Pellet Catcher User Manual

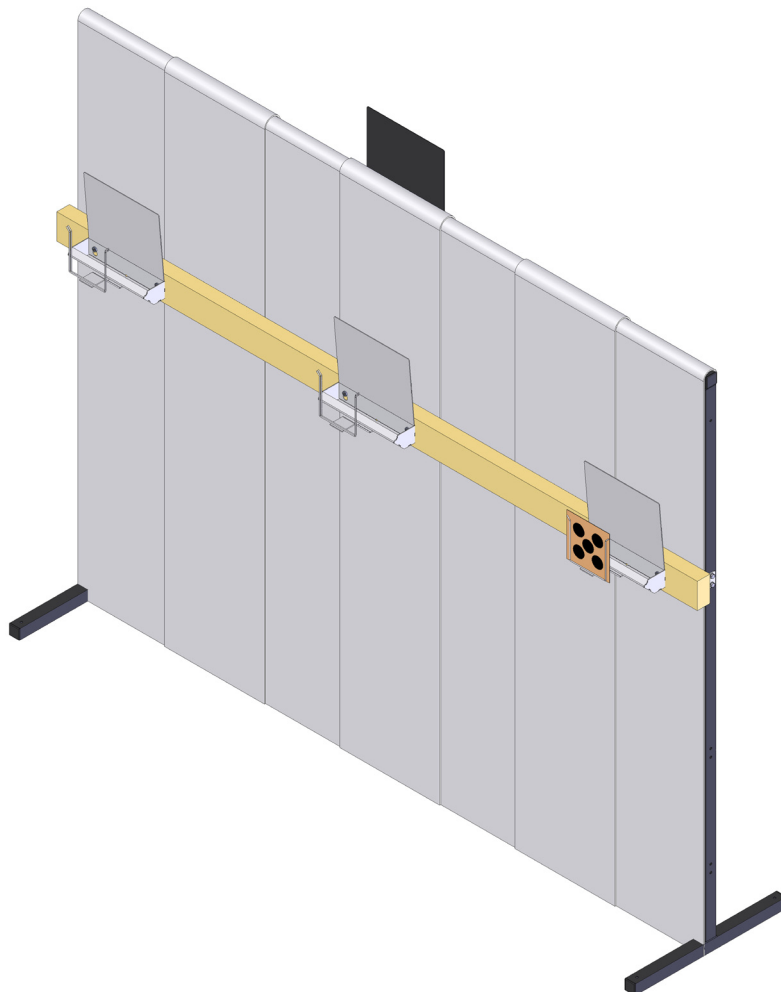

Table of contents

Page	4	-	Contents of kit and tools required
Page	5	-	Assembly of target screens
Page	7	-	Using the screen
Page	8	-	Target holder assembly
Page	10	-	Parts list and explosions

******* LIMITED LIABILITY WARRANTY *******

This product is warranted to the retail customer for 12 months from date of purchase against defects in materials and workmanship and is transferable to any subsequent owner.

Proof of purchase is required to receive warranty repairs, please retain your purchase invoice.

What is covered

Replacement parts & labour on a 'back to base' basis, return transportation to the consumer (mainland UK only).

What is not covered

Transportation from the consumer to Air Arms.

Damage caused by misuse, abuse, lack of routine maintenance, transit damage between the dealer/supplier and the consumer or unauthorized disassembly.

Parts subject to normal wear and tear.

Any other consequential cost incurred by the consumer.

Return transportation to consumers outside mainland UK.

No warranty is implied as to the fitness for any particular purpose.

Air Arms reserves the right to make changes without prior notice.

***Air Arms
Unit 5 - 6,
Hailsham Industrial Park,
Diplocks Way,
Hailsham,
East Sussex BN27 3JF.***

***www.air-arms.co.uk
general@air-arms.co.uk
01323 845853***

Contents of kits

The Air Arms target screen is a portable behind target screen designed for low power air rifles and pistols.

The kit comprises of two main assemblies. The first is a metal frame with thick flexible PVC sheets hung in an over-lapping curtain configuration. This is the target screen assembly. The second is the pellet catcher assembly, made up of a wood bar and three pellet catchers with target holders mounted in front of them.

List of components

Target screen

1	x	Frame top bar
2	x	Frame upright assemblies
2	x	Frame feet
6	x	Plastic end bungs
6	x	M8 washers
4	x	M8 nyloc nuts
16	x	3/4" washers
8	x	M6 bolts
2	x	M8 bolts
8	x	M6 nyloc nuts
1	x	Transfer plate
7	x	PVC screens
1	x	Roll of cord
1	x	Peribraid
4	x	Guy line sliders
4	x	Fixing pegs
1	x	Logo sticker

Pellet catcher

3	x	Target holder assemblies
3	x	Pellet catchers
12	x	M5 washers
8	x	M8 washers
6	x	M5 bolts
4	x	M8 nyloc nuts
6	x	Pellet catcher mounting boss
1	x	2.5m mounting bar
2	x	Mounting bar brackets
12	x	10 x 1 1/2" woodscrews
4	x	M8 bolts
6	x	M5 nyloc nuts

Tools required.

13mm socket to fit the M8 nuts.
10mm spanner for the M6 bolts and nuts.
8mm spanner for the M5 bolts and nuts
Philips head screwdriver

Assembly of the Target Screens

Fit the feet (No. 3) to the bottom of the uprights (No. 2) using a M8 nyloc nut and washer (No. 5 & 6). The feet have two holes cut into them, an 8.2mm hole for the bolt and a 20mm for clearance on the socket. The 20mm hole goes to the bottom of the assembly. On the bottom of the upright there is a flange, this flange needs to face front to back along the foot. Two plastic bungs (No. 4) can be pushed into the end of the feet.

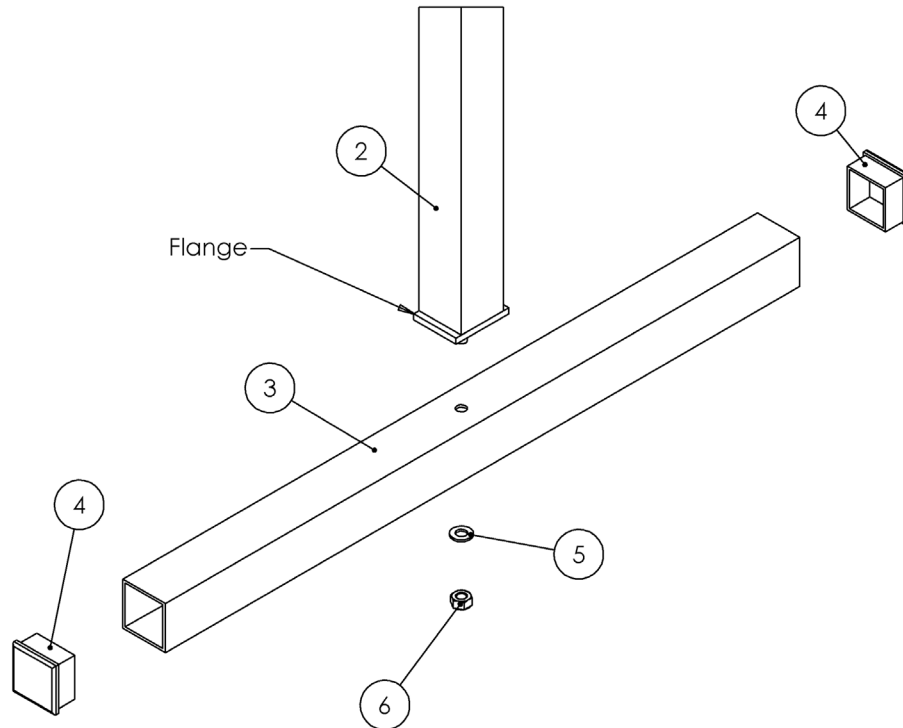

The Top bar (No.1) of the frame is held in place by a bolt (No.15) at each end. The flange on the uprights must face inwards to the top bar. Secure in place with the M8 x 60 bolt (No.15) and a M8 nyloc nut (No.10) being sure to fit a washer (No.9) between the head of the bolt and the top frame bar and the nut and flange.

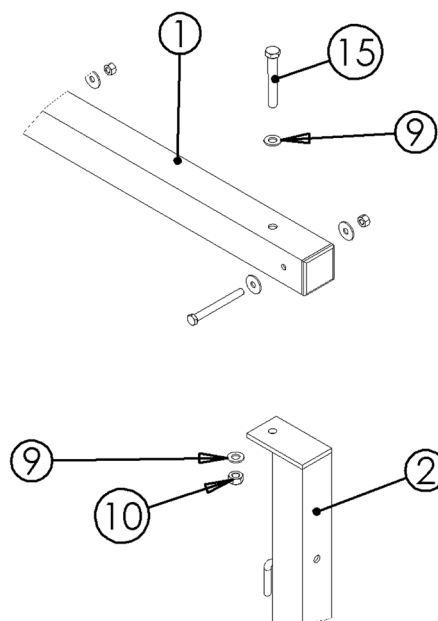

Once the frame work has been assembled and the nuts tightened the 7 PVC sheets (No. 11) can be mounted to the top member (No. 1). Each sheet needs to be secured with two bolts, each passing through two PVC sheets, except the end bolts which pass through one sheet. The sheets need to be assembled in a over and under pattern as shown below. The Sheets at the ends of the frame need to direct to the bar. the brace plate (TS01-1) needs to be fitted with each sheet as it is fitted as the image below shows.

Pass the M6 bolts (No. 13) with a washer fitted (No. 12), through from the front of the top frame bar and then through a sheet as shown below, put the brace onto the bolts and then another washer and a nyloc nut can now be fitted to secure the sheet. The sheet can then be hung over the front of frame top bar. This way the head of the bolt is protected from any stray pellet by the PVC sheet.

The logo plate can also be fitted at the same time to the two centre screws.



Screen shown without braces to show sheet configuration

Bolt head protected under the PVC sheet.

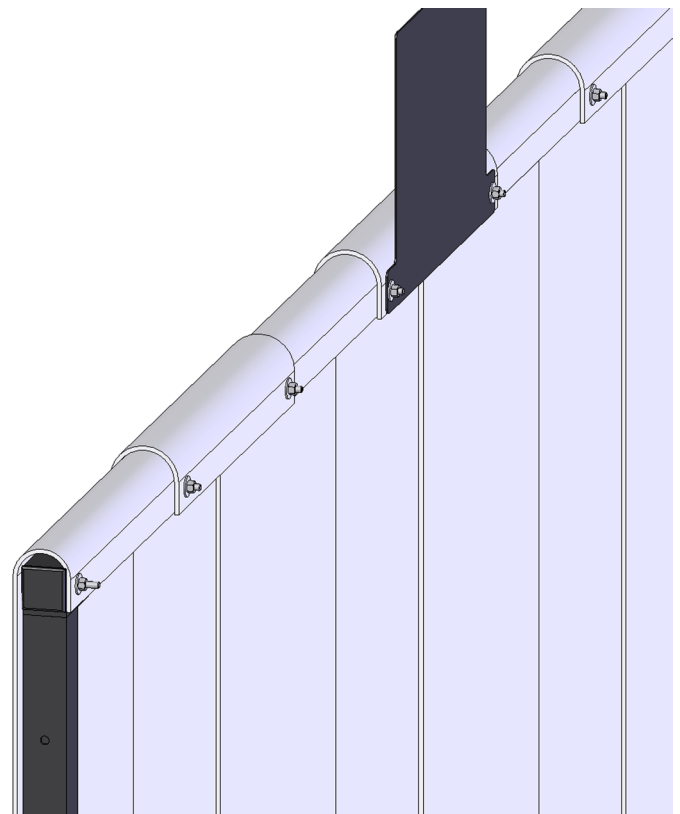
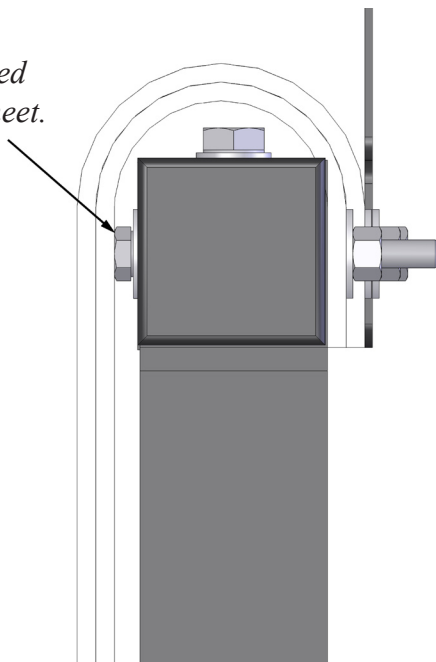

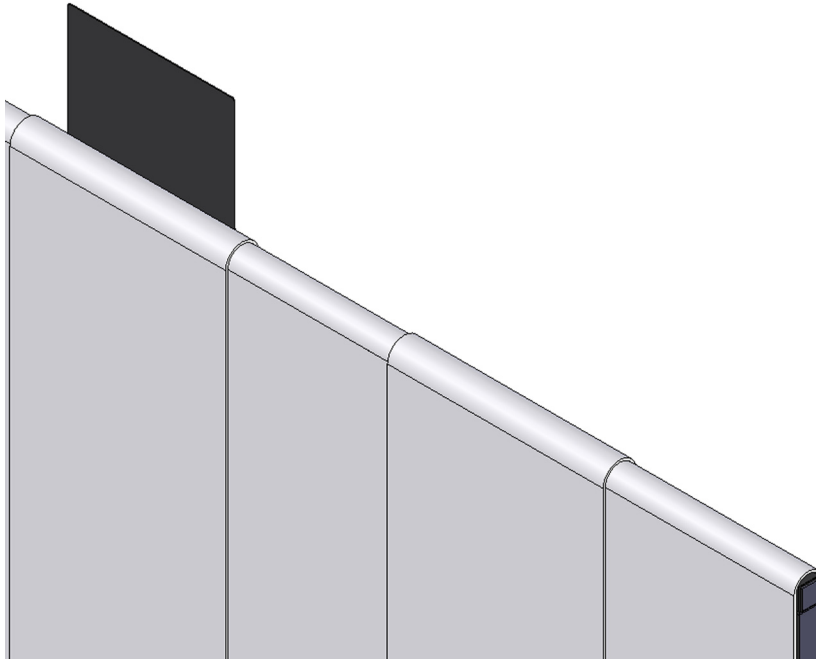

Using the screen

Positioning the screen

This screen has been designed for use with or without guy lines. It is recommended that if the frame is used on soft ground the guy lines should be used to aid stability. If the frame is used on flat level ground the guy lines may not be necessary.

If the guy lines are used, place the loop over the hook on the upright and pass through the hole above the hook as shown below. There are also holes in the feet of the frame through which the pegs can be used to hold the frame down.

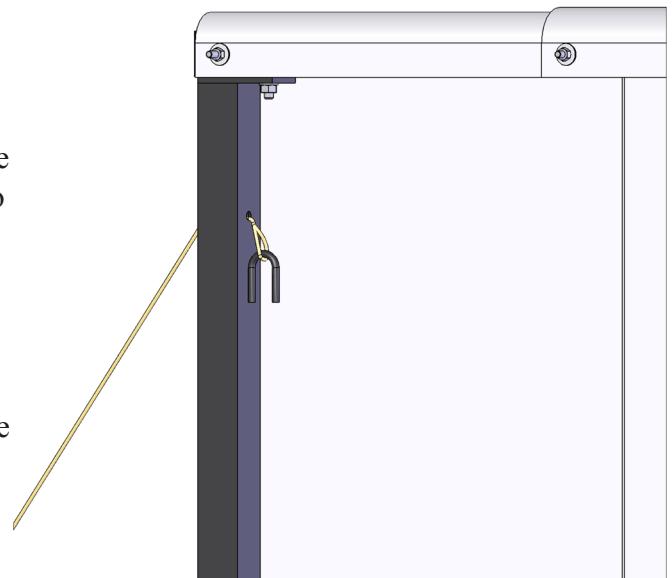

Shooting

When using the screen without an Air Arms target holder assembly the target should be placed about 30cm in front of the curtain, where possible in the centre of the frame. This will allow as much protected area as possible. The target holder assembly will be explained in the next section.

The screen has been designed for low powered air rifles and pistol shooting from a distance of 10 metres. Using higher power airguns or other types of rifles or pistols may damage the screens.

NOTE: The screens should be inspected before and after use to make sure they are sound. The curtains have fixing holes top and bottom so can be turned around if necessary. Spare curtains are available from Air Arms. See parts lists at the back of the manual.

The Target Holder assembly

The target holder assembly comprises of three pellet catchers and target holders mounted to a wooden bar. This bar can be fitted to the Target Screens at three height positions.

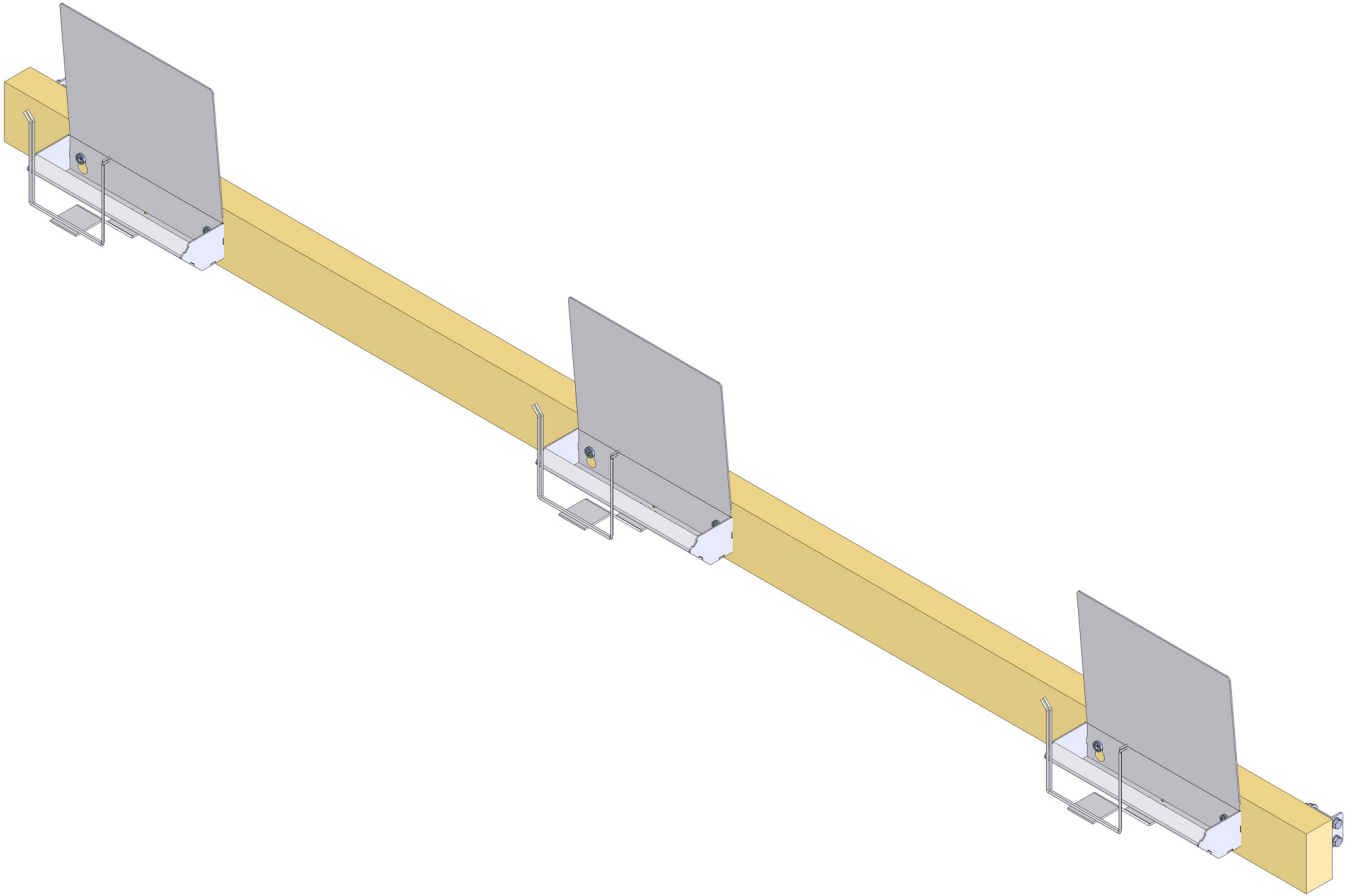

The assembly of the target holder is straight forward and you will find an exploded diagram in the back of this manual showing where all the parts go.

One area requires extra mention. The mounting boss (No.10) for the pellet catcher must not be over tightened as this may make it difficult to slide the keyway on the back of the pellet catcher over the boss.

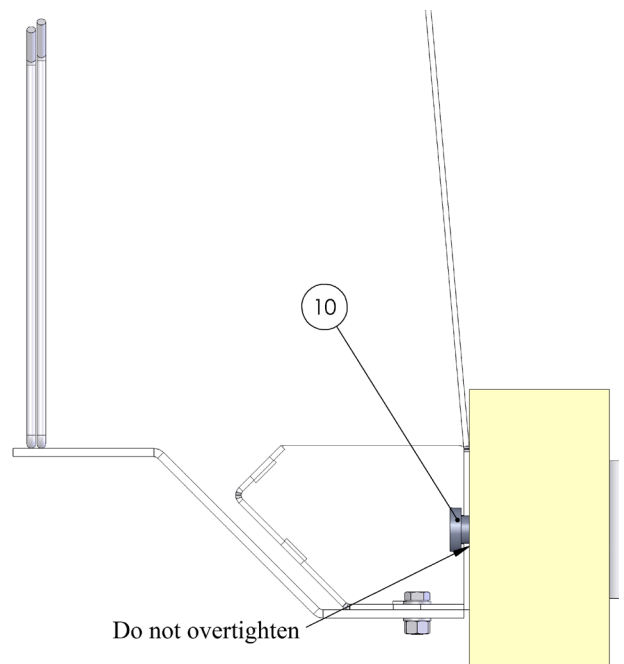

The pellet catcher can be set to three different positions on the target screen. These are for standing, kneeling and prone.

There are holes to bolt the pellet catcher assembly to the frame in the three positions requires, use the M8 bolt, nuts and washers provided no (No.15, 10 & 9).

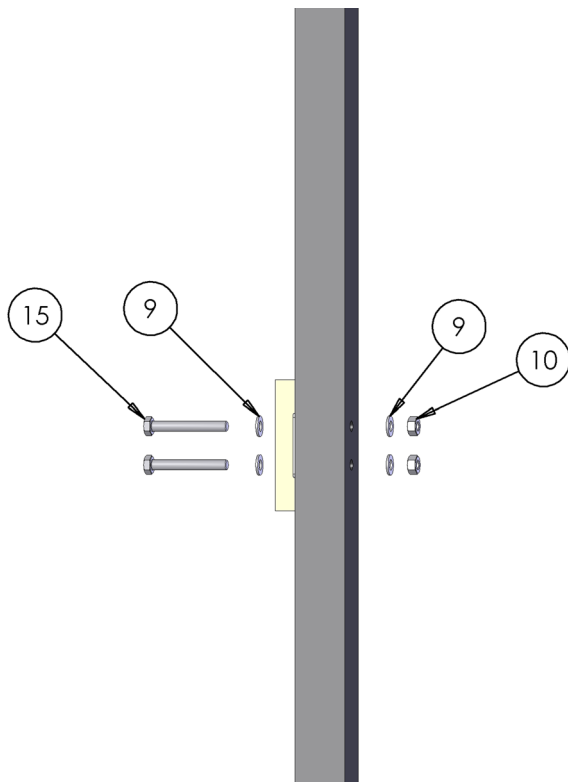

ITEM NO.	PART NUMBER	DESCRIPTION	FITTED SHEET/QTY.
1	TS13	FRAME TOP BAR	1
2	TS07A	FRAME UPRIGHT ASSEMBLY - TARGET SCREENS	2
3	TS06	FRAME FOOT	2
4	SNKR20	BUNG	6
5	T2016	M8 X 25 X 1.5 WASHER	6
6	T0071SP	M8 NYLOC NUT	4
7	RW27	3/4 X 1/4 X 17G WASHER	16
8	TS11	M6 X 65 BOLT	8
9	SNKR26	M8 X 60 BOLT	2
10	RW13	M6 NYLOC NUT	8
11	TS12	TRANSFER PLATE	1
12	TS01	PVC SCREENS	7

ITEMS NOT SHOWN ON DRAWING INCLUDED IN KIT		
PARTS NUMBER	DESCRIPTION	QTY.
250/04/0275/07	CORD	16 METRES
VAC30BLACK	8mm BLACK PERIBRAID	0.15 METRES
TS04	GUYLINE SLIDER	4
TS05	FIXING PEG	4
TS10	AIR ARMS LOGO STICKER	1

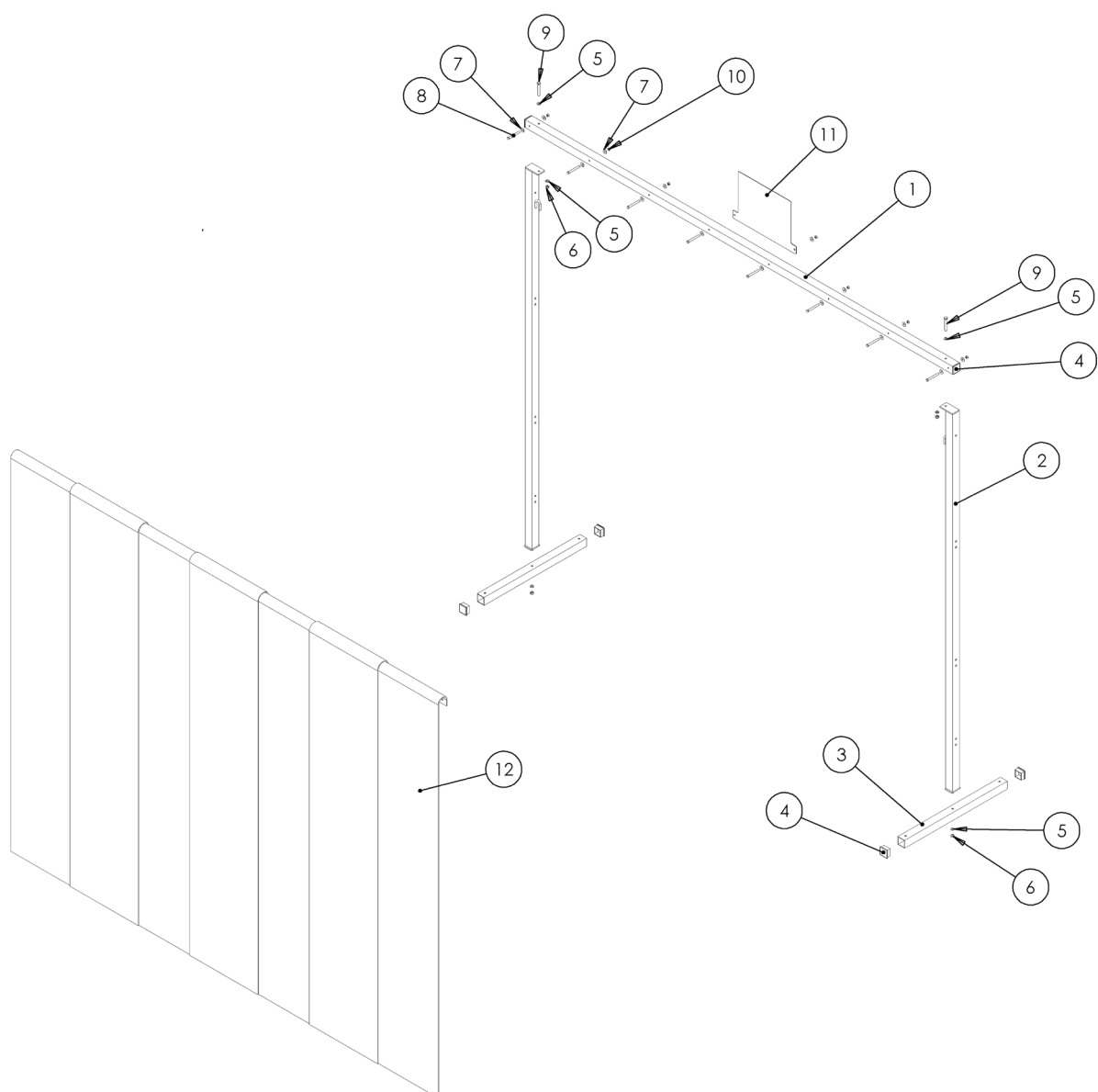

ITEM NO.	PART NUMBER	DESCRIPTION	QTY.
1	TS15	TARGET HOLDER ASSEMBLY	3
2	TS14	PELLET CATCHER	3
3	RW35	M5 WASHER	12
4	T2016	M8 WASHER	8
5	KDT009	M5 BOLT	6
6	T0071SP	M8 NYLOC NUT	4
7	TS17	PELLET CATCHER MOUNTING BOSS	6
8	TS16-25	2.5M MOUNTING BAR	1
9	TS18	MOUNTING BAR ANGLE BRACKET	2
10	TS20	10 x 1 1/2" WOOD SCREW	12
11	SNKR26	M8 X 60 BOLT	4
12	KDT005	M5 NYLOC NUT	6

